

Angular Contact Ball Bearings

Brass cage angular contact ball bearing-7326 BCBM

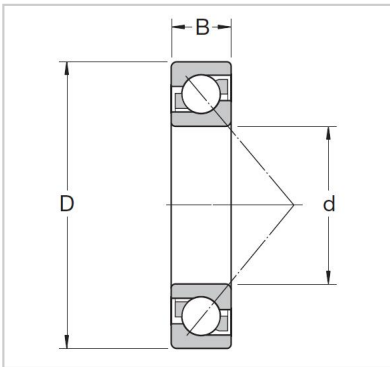

Abutment and fillet dimensions

Db max.	7326 BCBM
Da max.	7326 BM
da min.	130
rb max.	280
ra max.	58

Dimensions

a	276
r3,4 min.	305
r1,2 min	9
D1	2 800
d2	2 800
d1	17

Mass

KG	189
----	-----

Speed ratings r/min

Limiting speed	161
Reference speed	228

Fatigue load limit

Pu kN	4
-------	---

Basic load ratings KN

dynamic C kN	1.5
static Co kN	115

Basic design bearing

B mm	147
D mm	263
d mm	271

Basic design bearing

	3
--	----------

Designations

Universally matchable bearing	1.5
-------------------------------	-----